

Step 6: Lock the Partition using the rubber stoppers

On the bottom of the partition, stretch the rubber transport locks over the dome shaped dead-bolt to prevent the partition from opening. Make sure to do this for transport locks on each side.

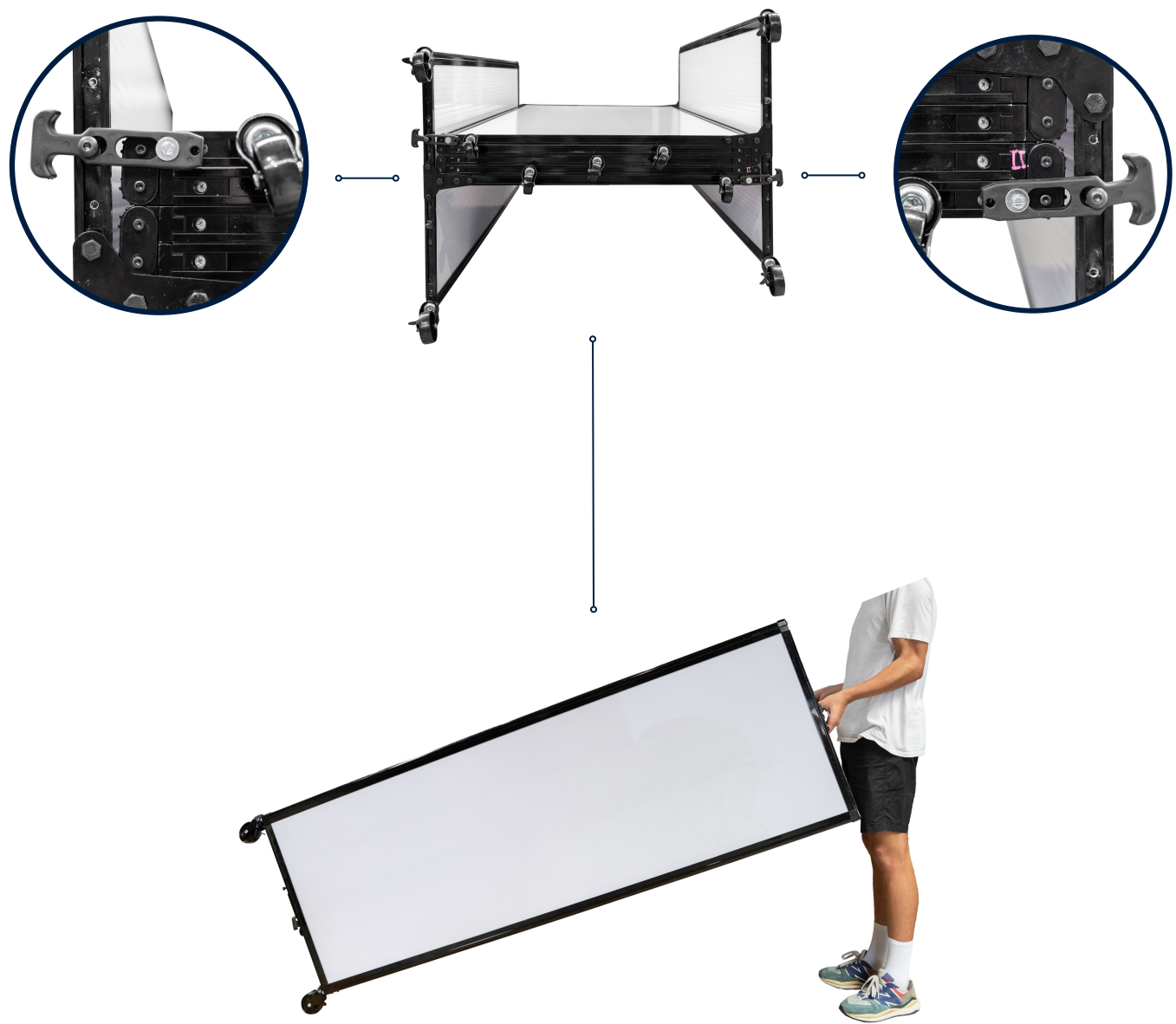

Step 7: Carefully lift the partition into place



360 Degree - Acoustic Room Divider

Assembly Guide - 5 panel



Box 1

Box 2

Box 3

- | | | |
|---|--|--|
| <ul style="list-style-type: none">• 1 Main 3-Panel section (marked I)• 4 T-Brackets• 2 Hinge Connectors• 1 Allen Key | <ul style="list-style-type: none">• 1 Main 2-Panel section (marked II) | <ul style="list-style-type: none">• 2 End Panels |
|---|--|--|



4 T-Brackets



2 Hinge Connectors



Allen Key



Shifter*

Additional tools
required

*not provided

Step 1: Create your work surface

Set up a work surface with two sturdy boxes of the same height that are over 34cm high and less than 80cm wide to make attaching the End Panels easier.



Step 2: Place and align the Main Panels

Place all Main Panel sections one on top of the other in descending order. Make sure the panels frames rest on the work surface to avoid damage.

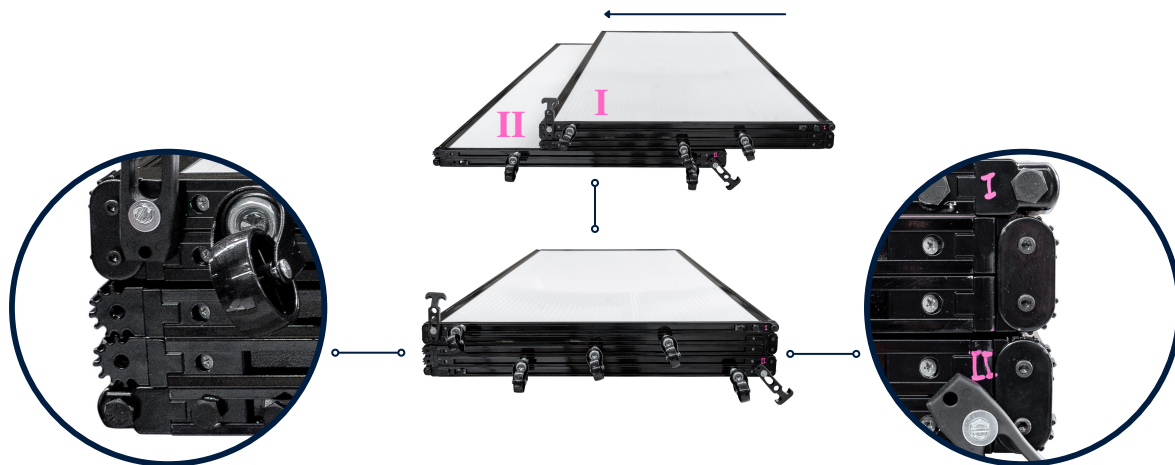

Step 3: Assemble Hinge Connectors

Look for the wheels to identify the bottom edge of the panels and screw in a Hinge Connector in the space provided. Tighten with the Allen key.

Once tightened, loosen each screw by 1 full 360 degree rotation anti-clockwise to allow free hinge movement. Repeat the process for the top edge of the panels.



Step 4: Prepare the End Panels

Get an End Panel and use a shifter to remove the bolts from the bottom and top sides. Attach the T-Brackets making sure the bolts are aligned with the marks provided. Tighten top and bottom bolts with the shifter. Repeat for the second End Panel.

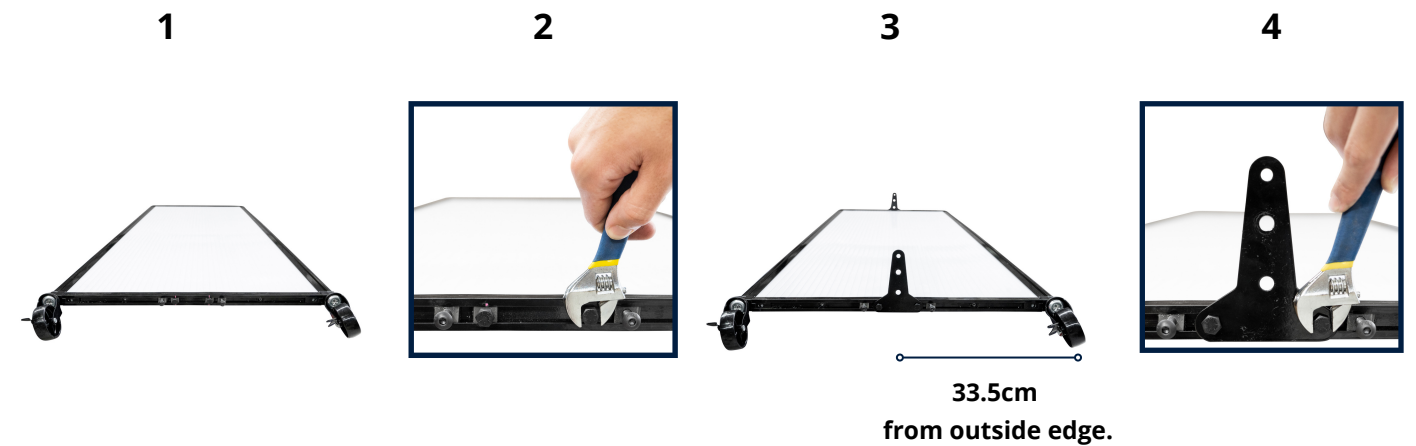

Step 5: Attach the End Panels to the Main Panels



Remove the three bolts already in place at the top and bottom edges of the main panels.

With help, lift an End Panel and align the holes of the T-Brackets with the holes of the bolts on the top and bottom sides of the Main Panels. Place the bolts and finger tighten.



Tighten the bolts with the shifter to secure in place.

Repeat the same steps to attach the second End Panel on the other side of the Main Panels